

1300 Industrial Road, Unit #19  
San Carlos, CA 94070

Tel: 1-(650)-595-LUMA(5862)

Fax: 1-(650)-595-5820

Email: [info@lumascap.com](mailto:info@lumascap.com)

FREE CALL 1-866-695-LUMA(5862) US & Canada

LUMASCAPE USA  
INC.

LS853

Ingrade

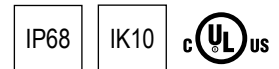

### Specifications

|   |  |
|---|--|
| <b>Lamp source</b>                            | 39W, 70W MH / HIT T6 (G12)<br><i>Remote control gear only</i>  |
| <b>UL classification</b>                      | Suitable for wet locations   |
| <b>IP rating</b>                              | IP68   |
| <b>Construction</b>                           | 316 marine grade stainless steel   |
| <b>Installation types</b>                     | Direct burial, landscapes, etc.<br>Pre-installation blackout, drive-over or other installations requiring pre-installation mounting kit. |
| <b>Drive-over</b>                             | With <b>OptiClear™</b> lens and pre-installation blackout (LS6052-K)   |
| <b>Static load rating</b>                     | 9 260 lb (4 200kg) with <b>OptiClear™</b> lens and pre-installation blackout (LS6052-K)  |
| <b>Impact rating</b>                          | IK10 with <b>OptiClear™</b> lens   |
| <b>Standard inclusions</b>                    | Teflon coated cover screws<br><b>MicroAntiLeach™</b> cable entry<br>Thermal cutout   |
| <b>Ambient operating temperature</b>          | 32°F to 122°F (0°C to 40°C)  |
| <b>Warranty</b>                               | 10 year structural, 1 year electrical  |
| <b>Accessories</b><br><i>Order separately</i> | Refer to accessories table behind  |
| <b>Photometrics</b>                           | Refer to <a href="http://www.lumascap.com">www.lumascap.com</a>  |
| <b>Glass temperature</b><br>≤149°F (≤65°C)    | <b>HumanTouch™</b> compliant models<br>39W MH / HIT T6   |

*Any luminaire can become hot - take care with appropriate use and placement*



LS853 Round Flush Cover

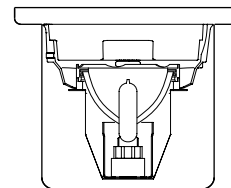

# LS853 Direct Burial

## Why Use Direct Burial

Direct burial installation is ideal for landscaping areas or in locations where the depth is restricted. This type of installation also allows for maximum heat dissipation. The stainless steel construction of the luminaire performs flawlessly in alkaline and acidic soil types, as well as chemically fertilized landscapes.

## Cable Entry Options for Direct Burial

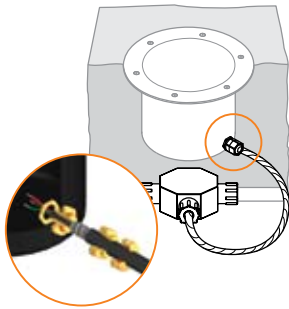

### Armored Cable MC & Splice Box

Armored cable 2ft (0.6m) provides protection against damage to cable between luminaire and 4 way splice box (included). Allows for loop in/loop out and flexibility of luminaire placement.

*Not available for RGB option*

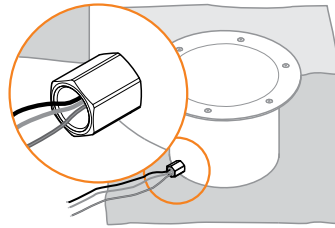

### Single Conduit Entry 0.5in NPT

For 0.5in conduit installation with **MicroAntiLeach™** cable entry c/w 6.5ft (2.0m) hook-up wire.

*Not available for RGB option*

## Lens Options

### OptiClear™ Glass



Glass of very high optical purity and load strength. Suitable for drive-over applications.

### GripGlass™

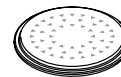

OptiClear™ glass with slip reduction glazing process. Suitable for drive-over applications.

### Borosilicate Glass



Ideal for general use areas. Not suitable for drive-over application.

## Cover Options for Direct Burial

Use recessed cover for installation in soil, grass, pavers and other uneven surfaces where no cover overhang is desired.



### Recessed Cover

- SS316: Polished
- SS316: Brushed
- Brass: Polished

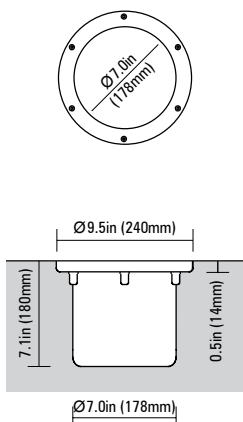

Use flush covers for installation in fine finished surfaces such as granite and marble. They can also be used in some suspended applications (decks, etc). The flush cover will conceal gaps between the luminaire and the surrounding surface.



### Round Flush Cover

- SS316: Polished
- SS316: Brushed
- Brass: Polished

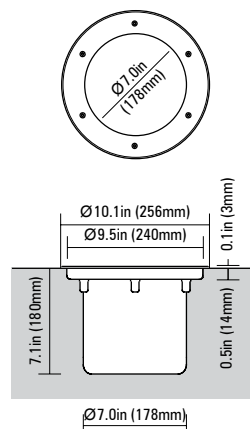

### Square Flush Cover

- SS316: Polished
- SS316: Brushed
- Brass: Polished

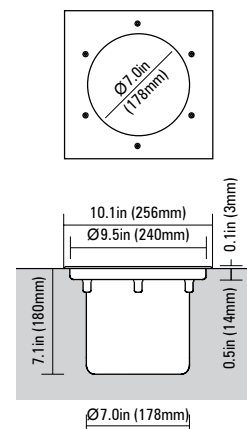

# LS853 Direct Burial (MH / HIT)

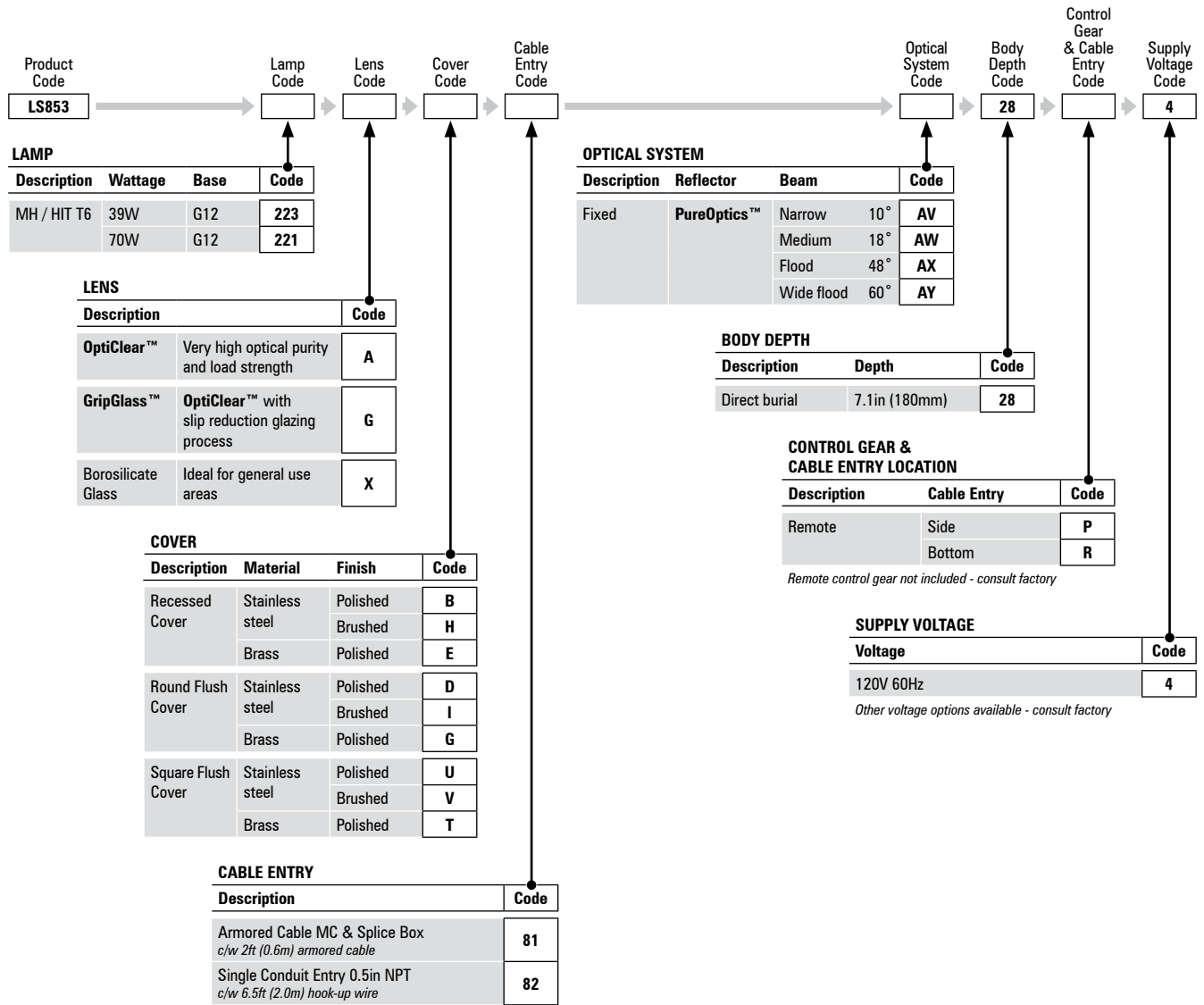

## Stacking and order of accessories

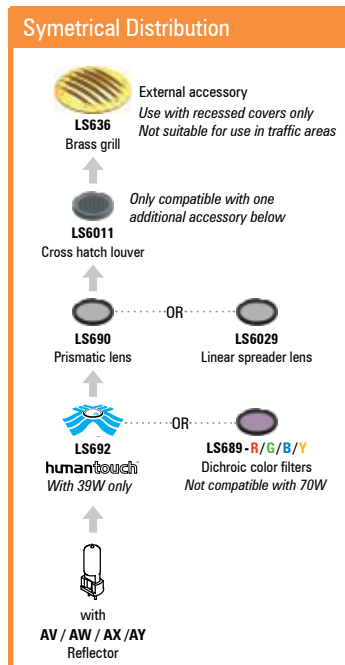

OR

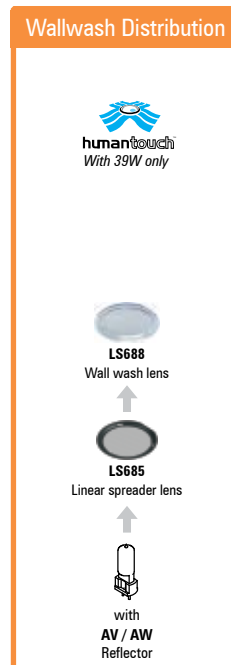

OR



*Other accessory stacking options may be available - consult factory*

# LS853 Pre-Installation Blockout

## Why Use Pre-Installation Blockout

This type of installation requires the LS6052-K pre-installation kit (order separately) which acts as a blockout, and is intended for installation before the luminaire. This method ensures the luminaire itself is not damaged during concreting or other site works, and also allows for all wiring to be completed prior to luminaire placement. Pre-installation also allows for off-site maintenance, via the detachable IP68 connector fitted on the luminaire housing. The mating connector on the cable has a sealing cap which ensures water does not enter the cable before the installation is completed. Pre-installation is required for all drive-over applications.

## Cable Entry Option for Pre-Installation Blockout

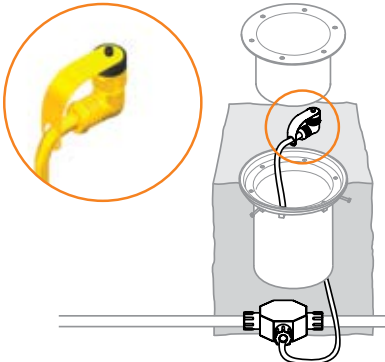

**IP68 Connector & Splice Box**

The luminaire is fitted with an IP68 connector, which attaches directly to the cable supplied with LS6052-K, without the use of any tools. The cable is 1.8ft (0.56m) in length, and is factory assembled with a 4 way splice box.

*For RGB option contact factory*

## Lens Options

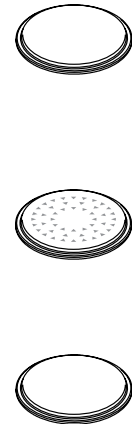

**OptiClear™ Glass**  
Glass of very high optical purity and load strength. Suitable for drive-over applications.

**GripGlass™**  
OptiClear™ glass with slip reduction glazing process. Suitable for drive-over applications.

**Borosilicate Glass**  
Ideal for general use areas. Not suitable for drive-over application.

## Cover Options for Pre-Installation Blockout

Flush covers for pre-installation use special seals and support bushes to ensure static loads up to 9260 lb (4200kg) are properly supported. In order to achieve this drive-over rating, **OptiClear™** or **GripGlass™** must be used.



**Pre-Installation Blockout Round Flush Cover**

- SS316: Polished   ■ Brass: Polished
- SS316: Brushed   ■ Brass: Brushed



Ø 10.3in (262mm)

Ø 7.5in (191mm)

11.0in (280mm)

# LS853 Pre-Installation Blockout (MH / HIT)

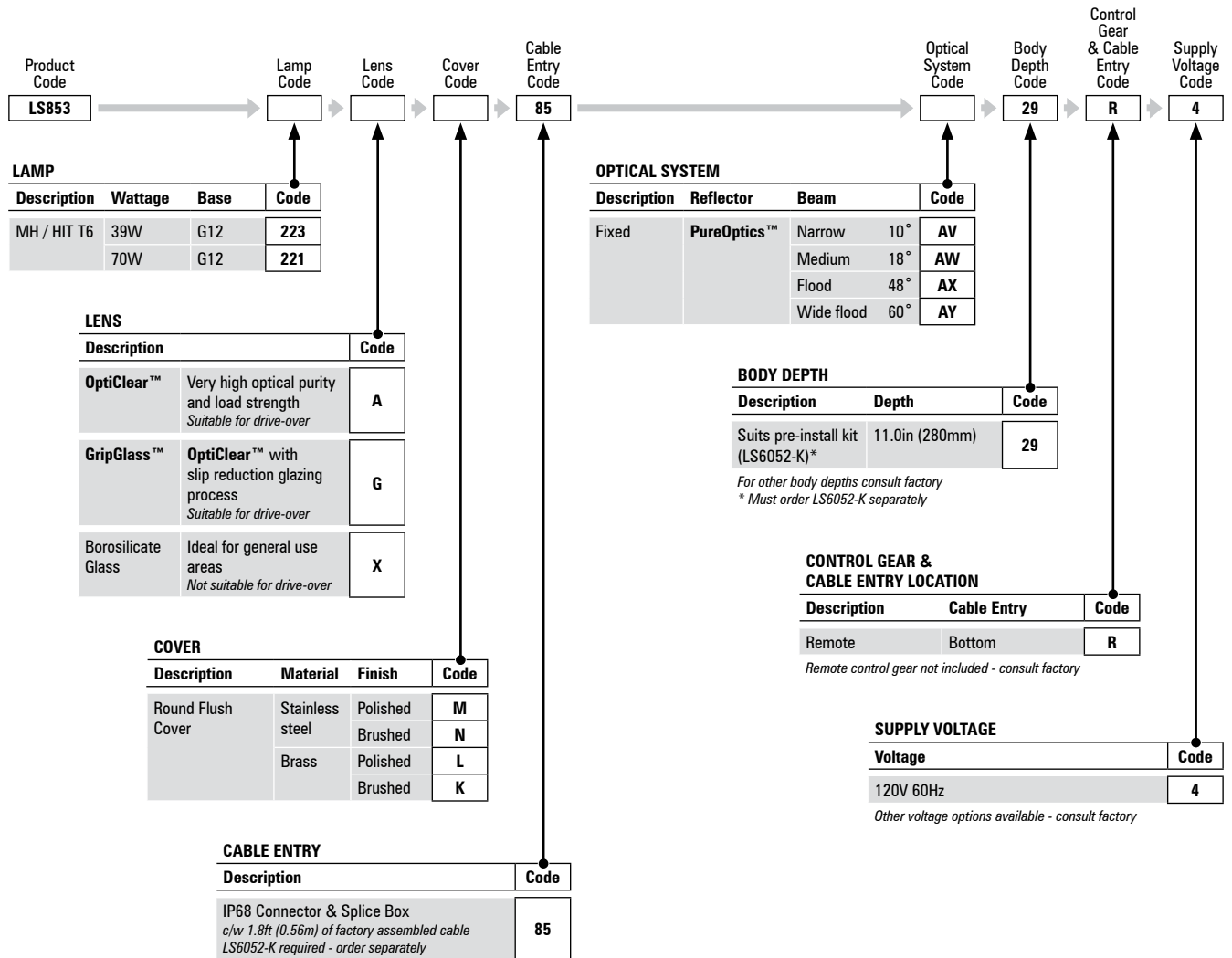

## Stacking and order of accessories

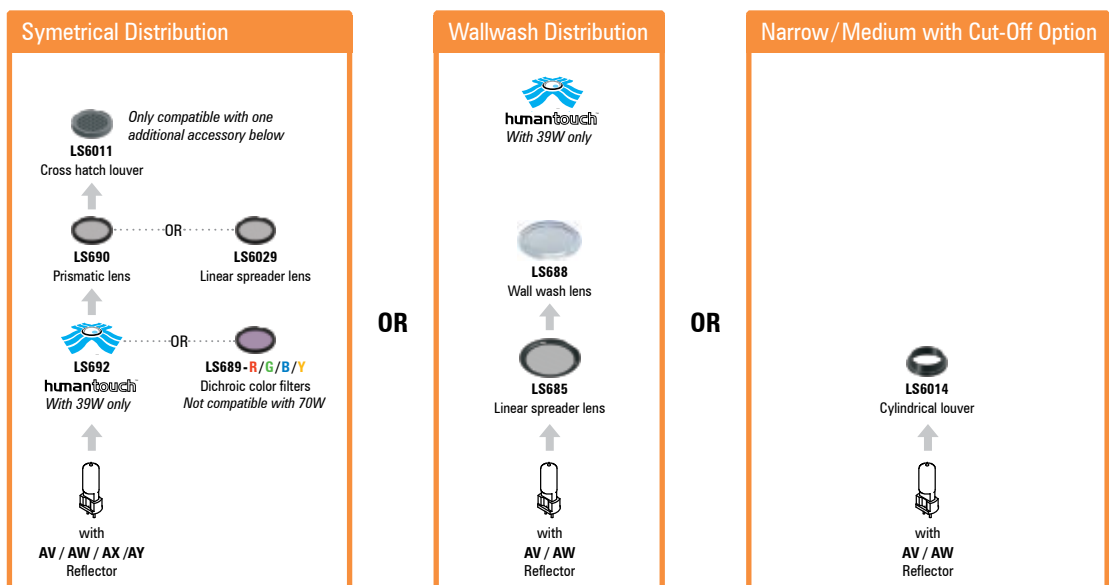

Other accessory stacking options may be available - consult factory