

# IMPORTANT INSTRUCTIONS

**A**  
START  
HERE

## For Installation LS343 Human Touch Retro-Fit Kits

**MODELS** LS651, LS652, LS654, LS655, LS657, LS658  
Human Touch Retro-Fit Kits for LS343 Series

A.C.N. 010 572 773

### WARNING

DO NOT SHORTEN, INTERFERE OR DISCONNECT CABLE FROM FITTING. WARRANTY WILL BE VOID IF CABLE ASSEMBLY IS TAMPERED WITH.

## Instruction Guide

### IMPORTANT NOTE:

Human Touch kits are available for LS343 series fixtures in 290mm & 350mm Bodies ONLY!

#### For Kit Numbers.

#### Follow Instructions Sets

LS657, LS658 Instruction Set A Followed by Instruction Set C

LS654, LS655 Instruction Set B Followed by Instruction Set C

LS651, LS652 Instruction Set C Only



LUMASCAPE  
USA INC.

### LUMASCAPE USA INC.

US Head Office  
1300 Industrial Rd., Unit #19  
San Carlos, CA 94070  
USA

Telephone  
1-(650)-595-LUMA(5862)

Fax  
1-(650)-595-5820

www.lumascope.com

### Free Call

1-866-695-LUMA(5862)

(US & Canada)

## Instruction Set A REFLECTOR GLASS ATTACHMENT FOR LS657, LSD658 ONLY

1

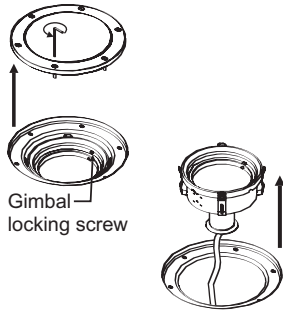

### Isolate and remove Gimbal

Check the fixture is electrically isolated. Unscrew & remove lid. Loosen gimbal locking screw and remove assembly.

2

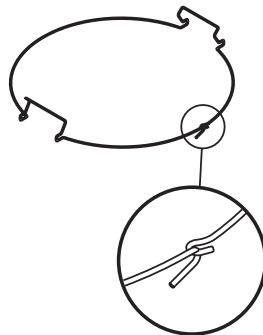

### Join clip ends

Ensure two hooks on clip are interlocked

3

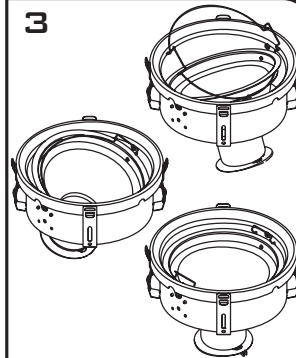

### Attach Clip to Reflector

Positioning the join under the lip of the reflector. Stretch the clip over the reflector as shown

4

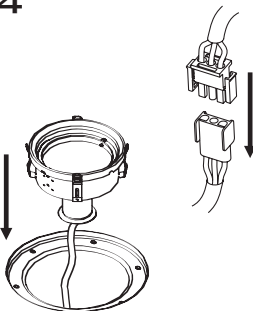

### Return Gimbal into Fixture

Connect & insert gimbal into fixture. Re-adjust Rotation, angle & depth. Lock off Gimbal.

5

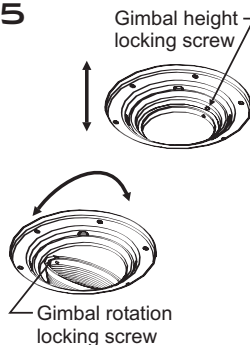

### Adjust Gimbal position

Re-aim gimbal to desired focal point. Lock gimbal depth and rotation.

6

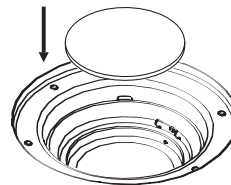

### Insert Reflector Glass

Insert reflector glass into clip on reflector. Ensure glass is flat and central against reflector. Avoid touching Glass as best as possible.



# IMPORTANT INSTRUCTIONS

## Instruction Set B LAMP GLASS ATTACHMENT FOR LS654 LS655 ONLY

**1**

**Isolate and remove Lid**  
Check the fixture is electrically isolated. Unscrew & remove lid.

**2**

**Remove louvre and hood**  
Check fixture is cool to touch and remove the hood and louvre

**3**

**Attach new Hood Assembly**  
Attach the new hood, filter louvre assembly to gimbal



**LUMASCAPE**  
USA INC.

**LUMASCAPE USA INC.**

US Head Office  
1300 Industrial Rd., Unit #19  
San Carlos, CA 94070  
USA

Telephone  
1-(650)-595-LUMA(5862)

Fax  
1-(650)-595-5820

[www.lumascope.com](http://www.lumascope.com)

**Free Call**  
**1-866-695-LUMA(5862)**  
(US & Canada)

## Instruction Set C SEAL GLASS ATTACHMENT FOR ALL LS343 HUMAN TOUCH KITS

**1**

**Locate Sealed Glass**  
Gently position the seal evenly into the top of the fixture

**2**

**Push Seal Evenly**  
Pushing on the seal itself, press the seal into the fixture with an even pressure

**3**

**Check position**  
Ensure the seal is located evenly against the gimbal. Care must be taken not to mis-align the gimbal.

## Instructions 4, 5 & 6 Applicable only with kits LS651, LS654 & LS657

**4**

**Separate Lid**  
Remove the lid and screws from the lid seal.

**5**

**Replace Glass**  
Peel seal away from glass. Check that seal is clean. Insert new glass into seal.

**6**

**Reassemble Lid & Clean**  
Reassembly Lid into seal, aligning holes. Insert screws into holes. Clean both sides of glass and reseal fixture.



Further information over page