

IMPORTANT INSTRUCTIONS

For Adjusting/Aiming of Refractor Lens

MODELS LS343-22 **** XT **** Wide (VN,MH)
 LS343-22 **** XP **** Ultra wide (VN,MH)
 LS343-22 **** XQ **** Very Narrow (VN,MH)
 LS343-22 **** XL **** (W, CFL)

www.lumascope.com

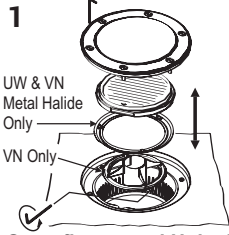

1 Open fixture and Unlock
 Loosen screws with allen key provided. If necessary gently lever lid out with large screwdriver. Remove components as shown. Loosen grub screw. Replace components.

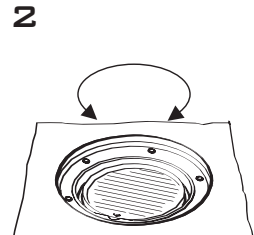

2 Aim fixture optics
 Turn fixture on. Rotate black spacer ring and lens until required result is achieved. Turn fixture off.

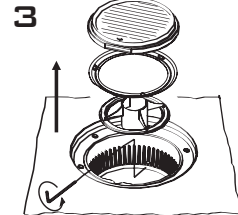

3 Lock reflector
 Carefully remove lens (and secondary glass, glare shield) and tighten grub screw. Apply gentle downward pressure to black spacer ring as screw is tightened.

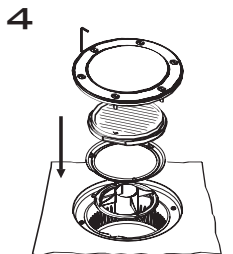

4 Replace lens and lid
 Replace lens (and secondary glass, glare shield) and outer cover assembly and reseal fixture.

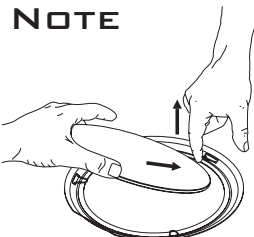

NOTE
Additional filter
 Additional filters, (137mm) can be added to the fixture by retaining beneath spring clips on the top of the secondary glass holder.

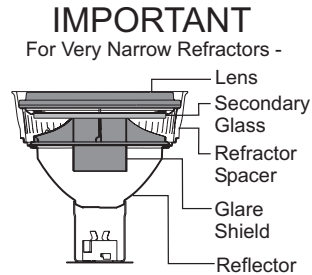

IMPORTANT
 For Very Narrow Refractors -

Ensure that glare shield, if supplied - VN models only, is fitted the correct way up as shown. Glare shield should seat neatly into fixture.

LUMASCOPE CONTACT DETAILS

C898US - 2006_07_REV001

• LUMASCOPE USA INC. 1300 Industrial Rd., Unit #19 San Carlos, CA 94070, USA • Free Call: 1-866-695-LUMA(5862) • Ph: 1-(650)-595-LUMA(5862) • Fax: 1-(650)-595-5820

IMPORTANT INSTRUCTIONS

For Adjusting/Aiming of Refractor Lens

MODELS LS343-22 **** XT **** Wide (VN,MH)
 LS343-22 **** XP **** Ultra wide (VN,MH)
 LS343-22 **** XQ **** Very Narrow (VN,MH)
 LS343-22 **** XL **** (W, CFL)

www.lumascope.com

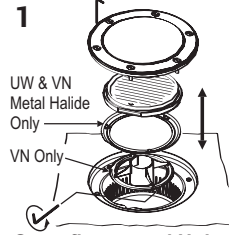

1 Open fixture and Unlock
 Loosen screws with allen key provided. If necessary gently lever lid out with large screwdriver. Remove components as shown. Loosen grub screw. Replace components.

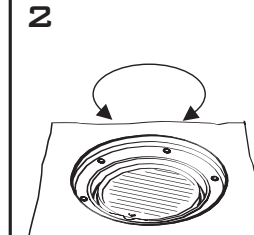

2 Aim fixture optics
 Turn fixture on. Rotate black spacer ring and lens until required result is achieved. Turn fixture off.

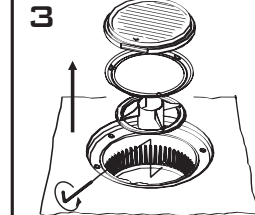

3 Lock reflector
 Carefully remove lens (and secondary glass, glare shield) and tighten grub screw. Apply gentle downward pressure to black spacer ring as screw is tightened.

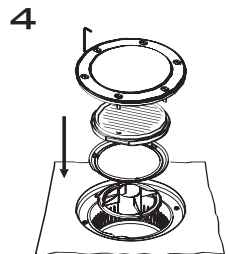

4 Replace lens and lid
 Replace lens (and secondary glass, glare shield) and outer cover assembly and reseal fixture.

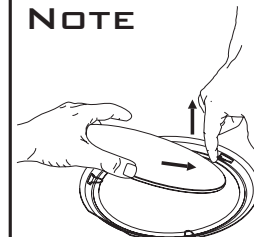

NOTE
Additional filter
 Additional filters, (137mm) can be added to the fixture by retaining beneath spring clips on the top of the secondary glass holder.

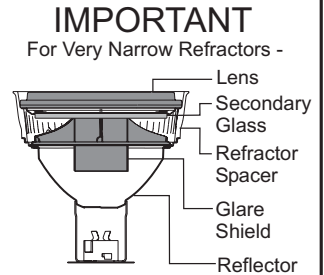

IMPORTANT
 For Very Narrow Refractors -

Ensure that glare shield, if supplied - VN models only, is fitted the correct way up as shown. Glare shield should seat neatly into fixture.

LUMASCOPE CONTACT DETAILS

C898US - 2006_07_REV001

• LUMASCOPE USA INC. 1300 Industrial Rd., Unit #19 San Carlos, CA 94070, USA • Free Call: 1-866-695-LUMA(5862) • Ph: 1-(650)-595-LUMA(5862) • Fax: 1-(650)-595-5820