



The Faisca F6 is an intelligent, ultra high-output marker light with a simple yet elegant design. that allows for easy and rapid installation. The plug and play electrical connections enhance the quick and easy installation process by preventing incorrect connections. Leader cables of up to 164 ft (50 m) give greater flexibility during installation as power supplies and control equipment can be housed well away from the luminaires. High-quality LEDs achieve high-intensity beautiful, rich and vibrant colors. From highlighting architectural elements to super-smooth crossfades and color flows.

Performance

Static White & Color	Transparent Flat Lens		Diffused Dome Lens	
	Lumen Output (lm)	Efficacy (lm/W)	Lumen Output (lm)	Efficacy (lm/W)
● 2,700 K (80 CRI)	2,270	123	1,490	82
● 3,000 K (80 CRI)	2,440	133	1,610	89
○ 3,500 K (80 CRI)	2,440	133	1,610	89
● 4,000 K (80 CRI)	2,840	154	1,870	103
● 5,000 K (80 CRI)	2,630	143	1,730	96

Dynamic Color	Transparent Flat Lens		Diffused Dome Lens	
	Lumen Output (lm)	Efficacy (lm/W)	Lumen Output (lm)	Efficacy (lm/W)
● RGBA	-	-	-	-
● RGBW (4,000 K) with Royal Blue	1,330	75	880	50

Tunable White	Transparent Flat Lens		Diffused Dome Lens	
	Lumen Output (lm)	Efficacy (lm/W)	Lumen Output (lm)	Efficacy (lm/W)
● 2,700 K - 6,500 K	2,450	133	1,610	89

*** NOTE:**
The default RGBW colors have recently changed to the RGBW with Royal Blue (4BW code). These colors will not match existing products with the earlier RGBW with Mid-Blue (4CW code). Contact Lumascape for custom LED Colors.



Electrical

LED Power	16 W
Power Consumption	≤20 W
Optics	Transparent Flat Lens or Diffused Domed with PureBlend Lens
Lifetime (L70)	> 60,000 hrs (B10, L70, TM21)
Input Voltage	30-48 Vdc
Thermal Management	CoolDrive™ onboard thermal monitoring and control

Control

Interface	Lumascap PowerSync ®
Protocols ¹	DMX/RDM, Artnet, PWM ² , 0 - 10 V (sink or source) ²
PWM Frequency	2 kHz flicker-free dimming to 0.1%
RDM Functionality	PowerSync enabled Lumascap luminaires are shipped with a default RDM personality which provides smooth dimming control. For different dimming characteristics or to enable other special functionalities, the default personality can be changed through industry standard DMX/RDM.
Systems	Range of third-party controllers

¹ Some protocols require additional hardware. For more information and other available protocols contact Lumascap.

² Not available for color-changing or tunable white

Physical

Housing	Marine-grade die-cast aluminum with UV protected and stabilized polymer diffuser
Finish	Superior 9-step powder-coating process, including marine-grade epoxy undercoat and polyester top coat
Installation	Surface-mounted
Ambient Operating Temperature	-40° F to 122° F (-40° C to 50° C)
Surface Temperature	≤122° F (50° C)
Weight	3.5 lbs (1.6 kg)
Effective Projected Area	Flat Lens; 0.09 ft ² (84.5 cm ²) Dome Lens; 0.11 ft ² (106 cm ²)
Effective Projected Area	0.9 ft ² (0.08 m ²) for 4 ft section

Certification & Compliance

IP Rating	IP66 / IP67 (Passes IP68 Test)
IK Rating	IK10
Environment	Dry, Damp, Wet locations
Certifications	ETL, CE, UKCA, RCM, FCC

Dimensions

Transparent Flat Lens

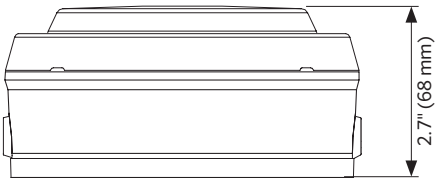

Front View

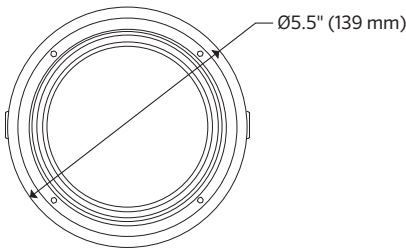

Top View

Diffused Dome Lens

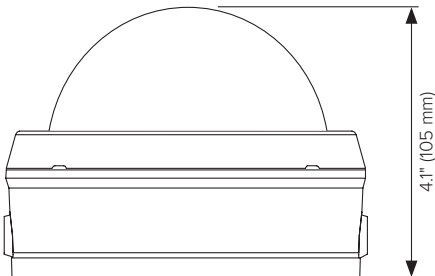

Front View

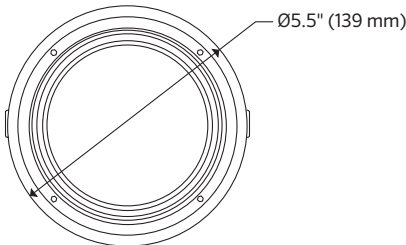

Top View

Luminaire Connection Type

Connectorized

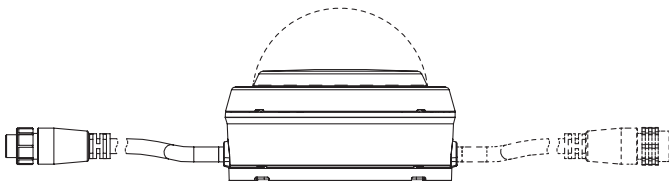

Side Entry

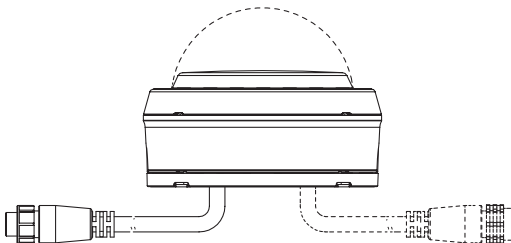

Bottom Entry

Accessories

Junction Box

For use with Connection Type '82' (hookup wire) and is ordered seperately.
Available in North America Only.



Specification Matrix

		LS6327
Product	Code	
UL Junction Box	LS6327	

Technical Drawings

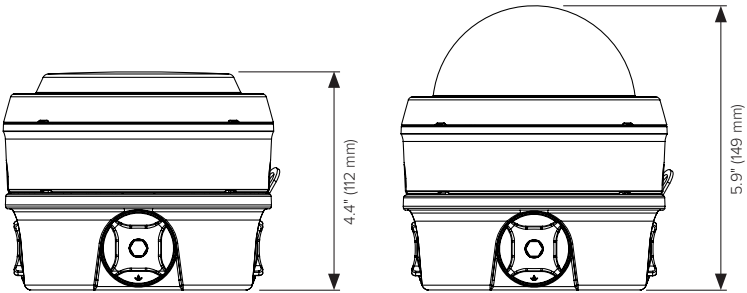
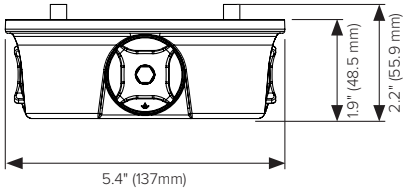

LS9260 – **16D**

Light Engine	Code
16 W	16D

Static White & Color	Code
2,700 K (80 CRI)	827
3,000 K (80 CRI)	830
3,500 K (80 CRI)	835
4,000 K (80 CRI)	840
5,000 K (80 CRI)	850

Dynamic Color	Code
RGBA	4CA
RGBW with Royal Blue	4BW ¹

¹ The default RGBW colors have recently changed to the RGBW with Royal Blue (4BW code). These colors will not match existing products with the earlier RGBW with Mid-Blue (4CW code). Contact Lumascape for custom LED Colors.

Tunable White	Code
2,700 K - 6,500 K	2WT

Connection Type	Code
Flexible single entry cable, for hardwired installations	84
Flexible entry/exit cables for hardwired installations (International market only)	83
Flexible single entry cable, for connectorized installations	67
Flexible entry / exit cables for connectorized installations	63
Hookup wire for hardwired installations (North America market only)	82

For other cable entry options, contact Lumascape.

Input Voltage	Code
30-48 Vdc (International)	07
30-48 Vdc (North America)	13

Control	Code
Non-Dimmable	ND ¹
PowerSync [®]	PS ²

¹ For single colour, non-dimming applications only.
² Required for all dimming and colour changing applications. LS6540 Data Injector is required (order separately).

Optics	Code
Flat Lens – Clear	DF
Domed Lens – Diffused	DC

Cable Entry	Code
Side	N
Bottom	O

Finish	Code
Black	BL
Anthracite Gray	AG
Basalt Gray	BT
Graphite Gray	GH
Anodic Silver	SL
White	WT
Dark Bronze	DB
Latte	LT
Dark Aluminum	DA
Custom RAL	CC ¹

¹ RAL color required

Network Topology – Low Voltage 30-48 Vdc Dimmable and Color-Changing via PowerSync™ 4

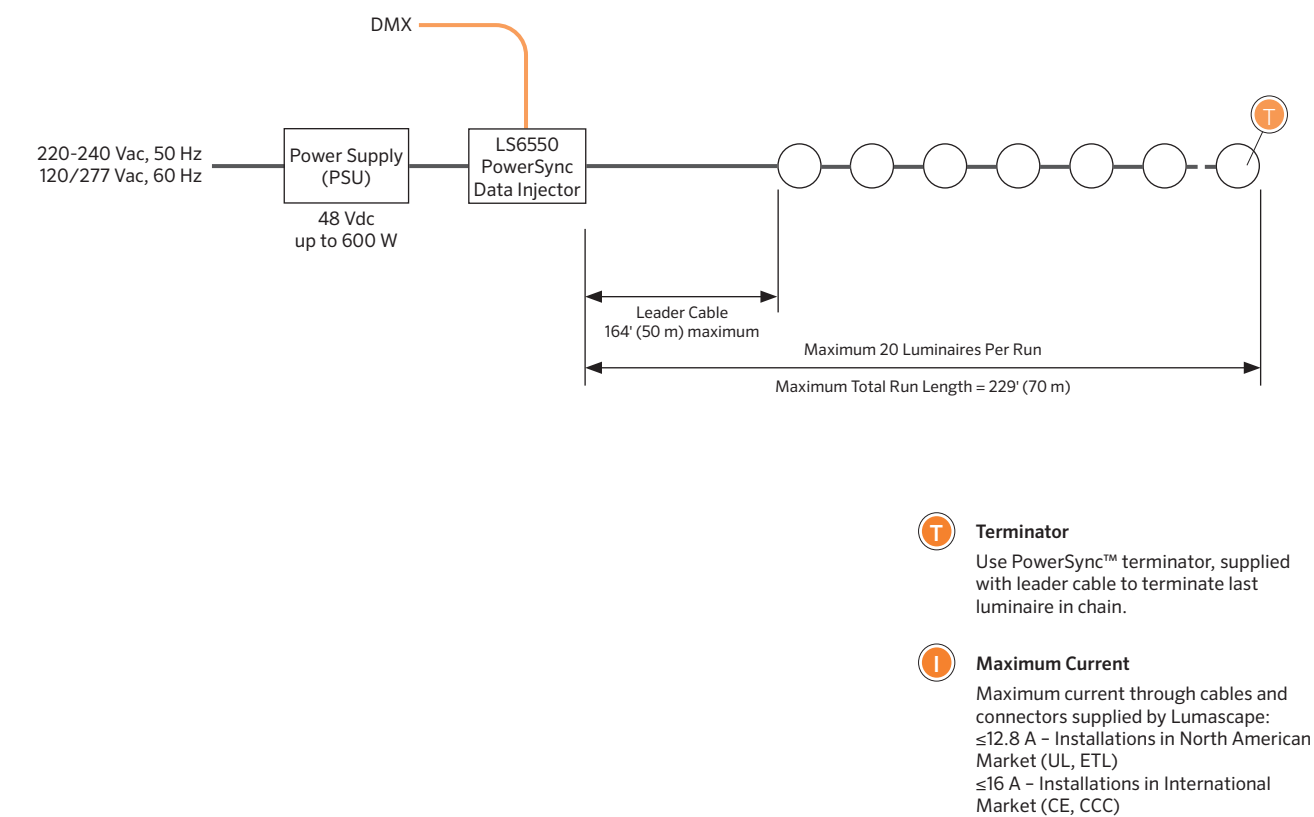

Up to 20 luminaires per 48 V PowerSync circuit / LS6550 Low Voltage PowerSync Data Injector

Maximum Circuit Loading - Single Run						
LED Power	Max Leader Cable Length from LS6550 to first luminaire	Maximum number of luminaires per 48 V Power Supply				
		120 W	240 W	320 W	480 W	600 W
20 W	50' / 15 m	4	9	12	17	20
	98' / 30 m	4	9	11	16	18
	164' / 50 m	4	8	10	14	15

Values in the above table show the maximum circuit loading per 48 V circuit.
Values are based on 4.0' (1.2 m) spacing. Smaller spacing may effect the circuit loading.
Extended fixture cables, inclusion of jumper cables, or longer leader cable will effect loading.
Circuits can be made up of up to 20 luminaires, up to the maximum circuit loading in the table above.
Circuits are limited to maximum 12.8 A.
For non-continuous runs, contact Lumascape for details.

Connectorized Accessories – Low Voltage 30-48 Vdc

Leader Cables – PowerSync™ Extra Low Voltage (For Connection Type 63 or Type 67)

3-core 16 AWG / 1.5mm² for use in CE/CCC and UL installations. Compatible with all luminaires with Type 63 or 67 connectorized supply cable option. Supplied fitted with an IP68 connector for pairing with the first connectorized luminaire in a Powersync4, Low Voltage circuit. Comes complete with a matching End of Circuit, Powersync4, extra low voltage terminator plug.

LS6426		-		
Cable Type	Code	Cable Type	Code	Length
1.5 mm ²	LS6426	Non-Dimmable	ND	10' (3 m)
		PowerSync	PS	16' (5 m)
				50' (15 m)
				66' (20 m)
				98' (30 m)

Jumper Cables – PowerSync Extra Low Voltage (For Connection Type 63)

3-core 16 AWG / 1.5 mm² for use in CE/CCC and UL installations. Compatible with all Luminaires with Type 63 connectorized supply cable option. Supplied fitted with IP68 connectors for joining between connectorized luminaires in a Powersync4, extra low voltage circuit.

LS6427		-		
Cable Type	Code	Cable Type	Code	Length
1.5 mm ²	LS6427	Non-Dimmable	ND	1' (0.3 m)
		PowerSync	PS	2' (0.6 m)
				3' (1 m)
				6' (2 m)
				16' (5 m)
				32' (10 m)
				50' (15 m)
				66' (20 m)
				98' (30 m)

Connectorized Accessories

Terminators

Product	Code
PowerSync Terminator Connectorized, Extra Low Voltage 30-48 Vdc (CCC, CE, UL)	LS6437

* NOTE:

- DMX Terminators ship with PowerSync Data Injectors.
- Terminators for hardwired PowerSync installations ship with PowerSync Data Injectors.
- Terminators for connectorized PowerSync installations ship with Leader Cables.
- Order separately for spares only.

PowerSync Low Voltage 30-48 Vdc Data Injector

Translates control signals into a digital format, delivering integral power and data to intelligent LED luminaires. This allows highly-granular addressing and high-speed digital control of every luminaire, using only three wires. The data injector is DIN rail mountable designed to be installed in a switchboard, next to the power supply and circuit breaker that is supplying power to the controlled lighting circuit. Accepts a growing list of standard protocols (0-10 V, DMX/RDM) for simple integration with a wide selection of control systems using these industry standard protocols.

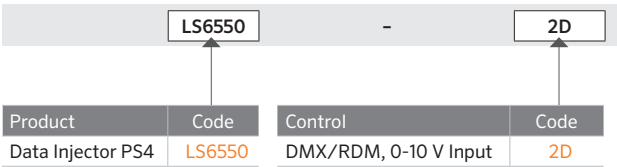

NOTE:

PowerSync Data Injector ships with three (3) hardwired terminators and one (1) hardwired DMX terminator.

Luminaire Wire Colors & Designations

Low Voltage 30-48 Vdc

Designation	Color
+ DC	Red
- DC	Black
Data	Orange

